

DIRECTIONS:

- FROM HWY 2 EXIT ONTO MCKENZIE ROAD EAST
- TRAVEL 1.8KM EAST TO 40TH AVE (RR273)
- TURN LEFT ONTO 40TH AVE (RR273) NORTH 1.8 KM
- TURN RIGHT AT CLEARVIEW DRIVE
- NEXUS ENGINEERING IS LOCATED ON RIGHT HAND SIDE

WE ARE DIRECTLY ACROSS FROM PACKERS PLUS BUILDING

ADDRESS:

BAY 3, 175 - 37428 RR 273
 RED DEER COUNTY, ALBERTA
 T4E 0A1
 403-314-0607 PHONE

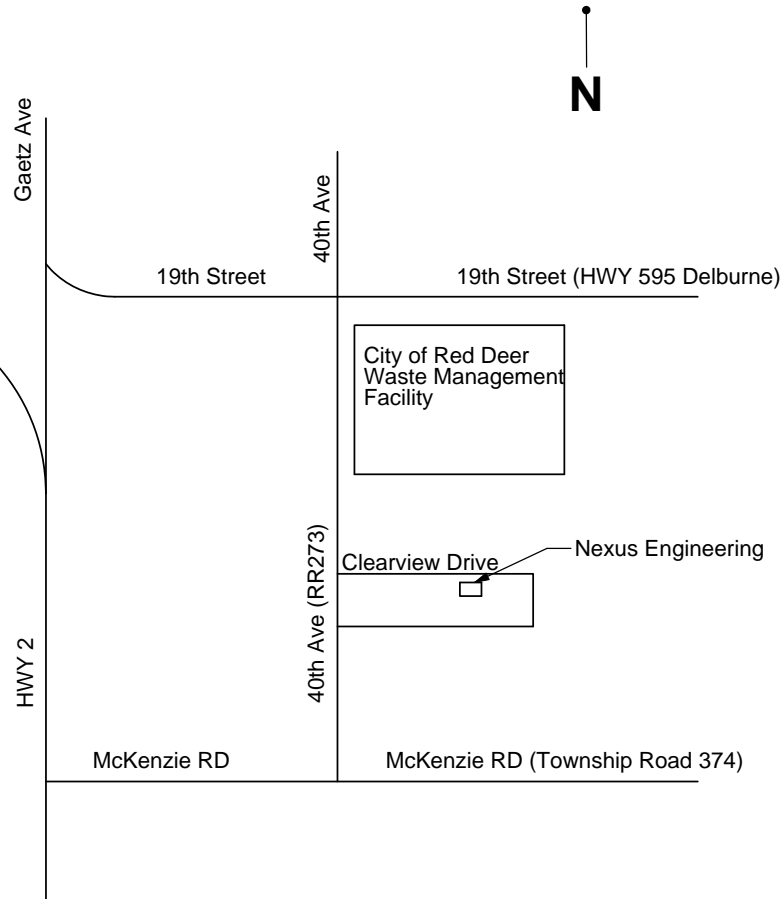

| | | | |
|--|-------------|---|---|
| Material: | | | |
| Heat Treat: | | | |
| Coating: | | | |
| Stamping: STAMP AS PER | | | |
| REV | DESCRIPTION | DATE | BY APP BY |
| | | | |
| | | | |
| | | | |
| The Information Contained in this Drawing is the Sole Property of Nexus Engineering & Machine Inc. Any Reproduction in Part or As a Whole Without the Written Consent of Nexus Engineering & Machine Inc. is Prohibited. | | UNLESS OTHERWISE SPECIFIED: | |
| | | Dimensions are in Inches x.x ± 0.030 Angles ± 0.5° x.xx ± 0.010 Fractions ± 1/32 x.xxx ± 0.005 | 125 rms Finish Min. Concentricity 0.005 T.I.R. Break All Sharp Edges ± 1/64 All Fillets & Radii 0.030 Max. |
| Status: Status | | Drawn By: none | Approved By: none Date: 02/11/99 |
| | | Project: Shop Map | Weight: lb |
| | | | Sheet 1 of 1 Revision: 0 |

